

# MILLER MEADOWS SUB PHASE 5, A CONSERVATION SUB

## FARMINGTON

Tax ID Prefix

**08-532**

Plat ID: 5379

Sheet 1 of 1

Year Recorded: 2014

Daniel Drive 475 W

550 South

Legacy Highway & Highway 67 & Hwy 67  
Legacy Parkway

Rigby Road

Daniel Drive 450 W

0501  
ROBINSON, JEREMY  
T & HOLLY M  
0.32 AC.  
456 W

0502  
MANSOUR,  
ABDALLAH  
0.32 AC.  
428 W

0503  
SANDERS, ADAM  
M & KASEY  
0.28 AC.  
398 W

0504  
MURBROOK,  
JAMES C & ALI  
0.34 AC.  
372 W

0505  
MOHR, CARSTEN  
TROY & JODIE B  
0.35 AC.  
346 W

501

502

503

504

505

Rigby Court  
600 S

510

509

508

506

0510  
SMITH, MATT O  
& ANDREA W  
0.35 AC.  
445 W

0509  
JAUSSI, PAUL J  
& KRISTIN T  
- TRUSTEES  
0.33 AC.  
415 W

0508  
SELANDER, CHAD  
& DANIELLE  
0.31 AC.  
387 W

0506  
LINTON, RYAN  
& LAURA  
0.4 AC.  
343 W

507

0507  
AMANTE, PAUL L  
& KRISTEN C  
0.3 AC.  
379 W

Daniel Court



1 inch = 60 feet

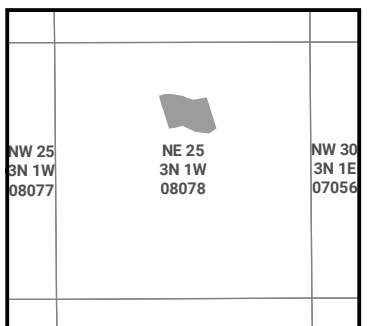

S L B & M

NOTE: Distance, bearings and radius values are approximate. User needs to refer to the recorded legal descriptions for exact bearing and distances. For cadastral or technical information, see the dedicated plat and or legal descriptions in recorded documents.



Last update: 5/22/2020