

# WESTWOOD COUNTRY ESTATES SUBD PHASE I AMENDED

KAYSVILLE

Tax ID Prefix

**08-193**

Plat ID: 2547

Sheet 1 of 1

Year Recorded: 1995



**Parcel ID**

**Lot Number**

1 inch = 100 feet

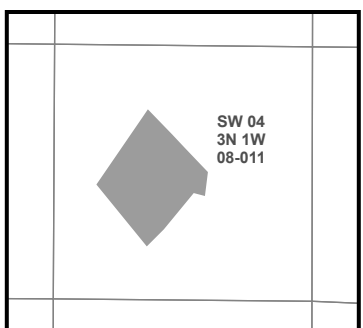

SLB & M

NOTE: Distance, bearings and radius values are approximate. User needs to refer to the recorded legal descriptions for exact bearing and distances. For cadastral or technical information, see the dedicated plat and or legal descriptions in recorded documents.

