

# BARTON ESTATES KAYSVILLE

Tax ID Prefix

**08-135**

Plat ID: 1979

Sheet 1 of 1

Year Recorded: 1990

350 South

370 South

Main Street  
SR 273 & Highway 273

0001  
GARDNER, DARIN  
K & MENDY S  
0.35 ac.  
170 E

1

0002  
WHITE, SCOTT C  
& JULEEN C  
0.42 ac.  
393 S

2

0003  
JENSEN, MARK A  
& DEETTE J  
0.42 ac.  
407 S

3

225 East

425 South



1 inch = 50 feet

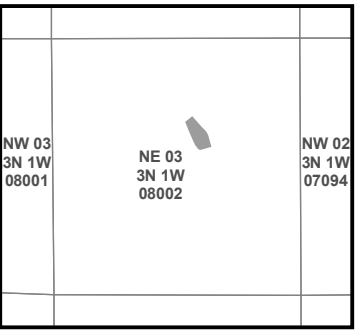

NOTE: Distance, bearings and radius values are approximate. User needs to refer to the recorded legal descriptions for exact bearing and distances. For cadastral or technical information, see the dedicated plat and or legal descriptions in recorded documents.

