

SE 1/4 SECTION 15 TP 3N RIW

PREFIX 08-067  
19

Salt Lake Meridian

SCALE 200 FEET=ONE INCH

LAST #0018

(See Erastus F. Rose Survey)

SEE PG. 08-065

214 216 216 217 218 219 220 221  
SHARPSHOOTER DR. (875 N.)

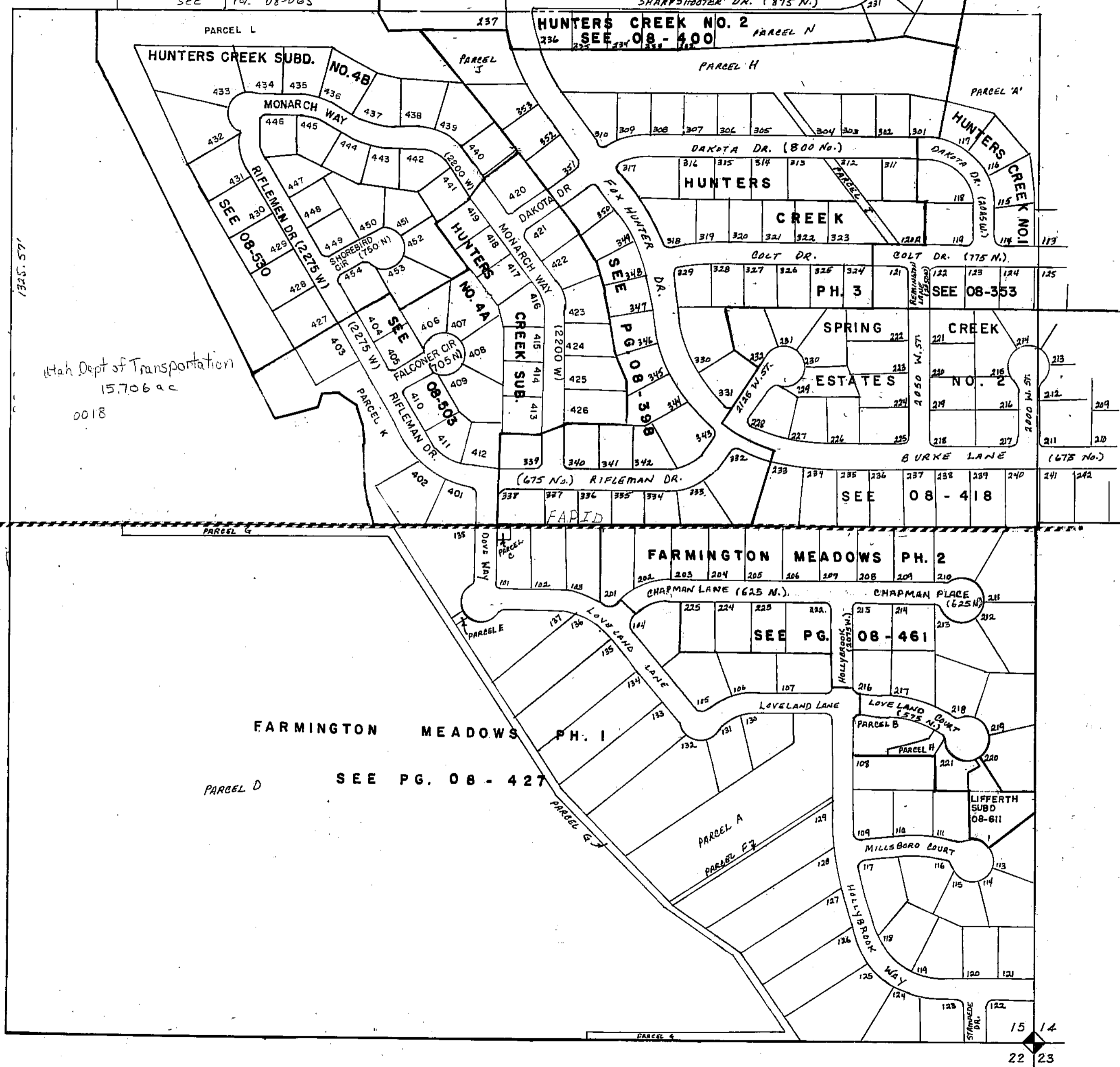

HUNTERS CREEK NO. 2  
SEE 08-400

HUNTERS CREEK SUBD. NO. 4B

PARCEL H

PARCEL 'A'

MONARCH WAY

RIFLEMAN DR. (2275 W.)  
SEE 08-530

HUNTERS CREEK SUB. NO. 4A

DAKOTA DR. (800 N.)

HUNTERS CREEK

DAKOTA DR. (800 N.)

COLT DR.

COLT DR. (775 N.)

PH. 3

SEE 08-353

SPRING CREEK

ESTATES NO. 2

Utah Dept of Transportation  
15.706 ac  
0018

BURKE LANE (675 N.)

SEE 08-418

(675 N.) RIFLEMAN DR.

FARMINGTON MEADOWS PH. 2

CHAPMAN LANE (625 N.)

CHAPMAN PLACE (625 N.)

SEE PG. 08-461

FARMINGTON MEADOWS PH. 1

SEE PG. 08-427

LOVELAND LANE

LOVELAND LANE

PARCEL A

PARCEL F

LIFFERTH SUBD 08-611

MILLSBORO COURT

HILLYBROOK WAY

HILLYBROOK WAY

HILLYBROOK WAY

HILLYBROOK WAY

HILLYBROOK WAY

15 14

22 23

067

08

09