

# WHISPERWOOD COVE SUBDIVISION PHASE 7B

KAYSVILLE

Tax ID Prefix

**07-223**

Plat ID: 3465

Sheet 1 of 1

Year Recorded: 2001

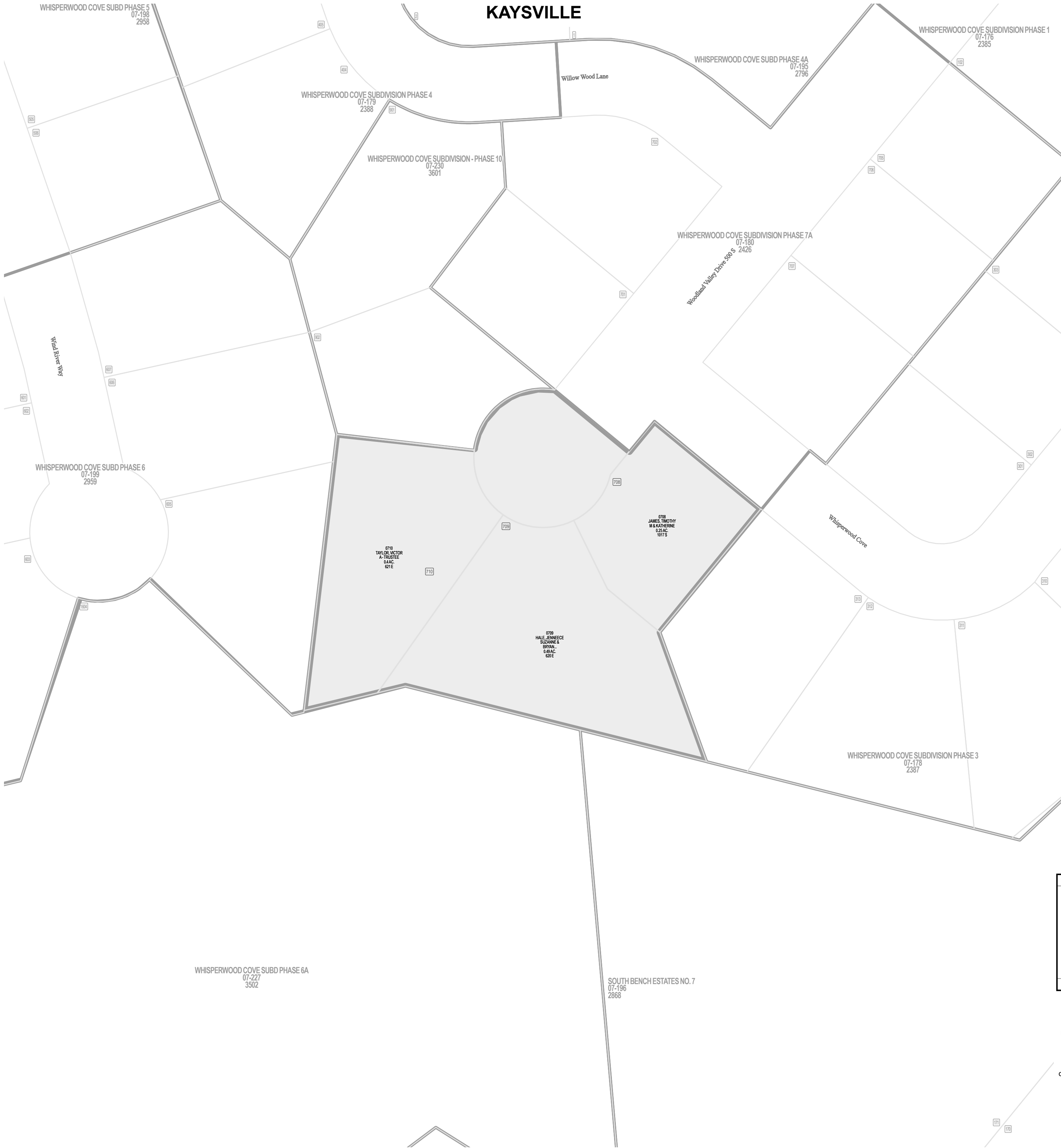

**Parcel ID**

**Lot Number**

1 inch = 50 feet

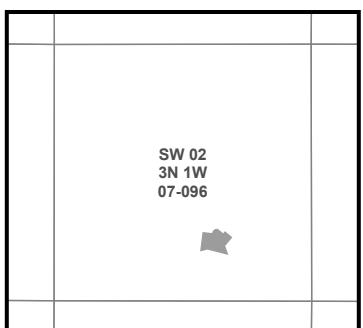

S L B & M

NOTE: Distance, bearings and radius values are approximate. User needs to refer to the recorded legal descriptions for exact bearing and distances. For cadastral or technical information, see the dedicated plat and or legal descriptions in recorded documents.

