

WHISPERWOOD COVE SUBD PHASE 8

KAYSVILLE

County

Tax ID Prefix

07-200

Plat ID: 2960

Sheet 1 of 1

Year Recorded: 1998



0804
DUNCAN, KEITH
R & COLETTE T
0.39 AC.
877 S

804

0803
HALES, JAMES F
& JANE D -
TRUSTEES
0.27 AC.
889 S

803

0802
SEEMILLER,
LANCE & MEGAN
0.23 AC.
581 E

802

0806
KEMP, MICHELLE
- TRUSTEE
0.28 AC.
569 E

806

0807
HERMANSEN,
RICHARD
0.28 AC.
557 E

807



1 inch = 40 feet

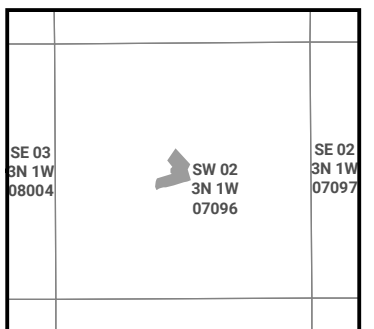

NOTE: Distance, bearings and radius values are approximate. User needs to refer to the recorded legal descriptions for exact bearing and distances. For cadastral or technical information, see the dedicated plat and or legal descriptions in recorded documents.

