

ROLLING HILLS ESTATES SUB PLAT L

CENTERVILLE

Tax ID Prefix

07-133

Plat ID: 1801

Sheet 1 of 1

Year Recorded: 1987



Parcel ID

Lot Number

1 inch = 50 feet

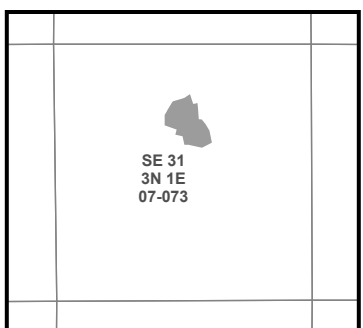

NOTE: Distance, bearings and radius values are approximate. User needs to refer to the recorded legal descriptions for exact bearing and distances. For cadastral or technical information, see the dedicated plat and or legal descriptions in recorded documents.

