

# JP ESTATES AMENDED

## WEST BOUNTIFUL

Tax ID Prefix

**06-441**

Plat ID: 6450

Sheet 1 of 1

Year Recorded: 2021

400 North

201

0201  
DESERT HARBOR  
LLC - ETAL  
1.908 AC.  
1141 W

202

0202  
CHRISTENSEN,  
MICHAEL & ERICA  
2.152 AC.  
321 N

N0°10'24"W  
42.00'

S89°43'36"W  
304.41'

S0°10'24"E  
42.00'

1100 West  
Howard St



1 inch = 60 feet

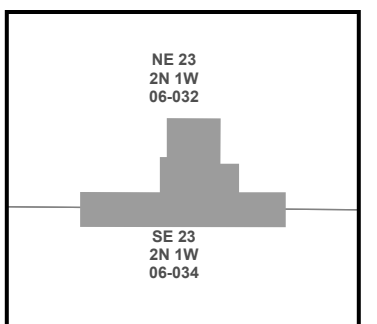

SLB & M

NOTE: Distance, bearings and radius values are approximate. User needs to refer to the recorded legal descriptions for exact bearing and distances. For cadastral or technical information, see the dedicated plat and or legal descriptions in recorded documents.



Last update: 12/2/2021