

# FOXBORO NORTH PLATS 3 & 8 AMENDED

Tax ID Prefix

**06-323**

Plat ID: 4967

Sheet 1 of 1

Year Recorded: 2009

Berkshire Drive 1075 W

NORTH SALT LAKE

Hillingdon Court 1055 W

Fox Hollow Drive 1030 W

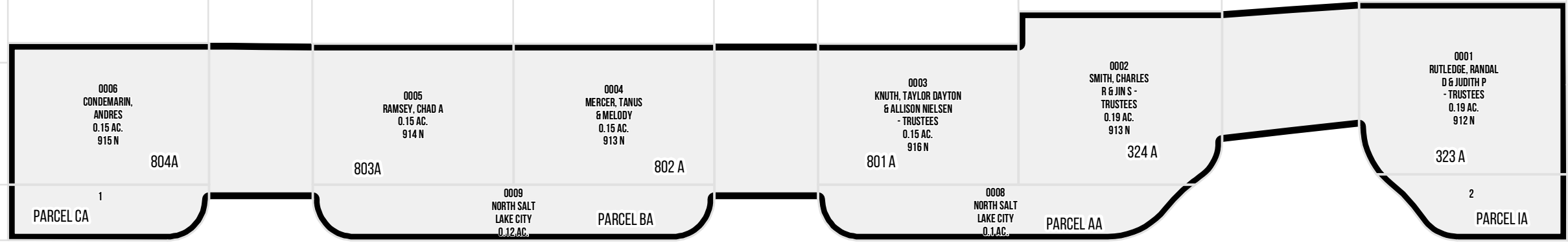

1. 0010 NORTH SALT LAKE CITY 0.06 AC.

2. 0007 NORTH SALT LAKE CITY 0.06 AC.

900 North

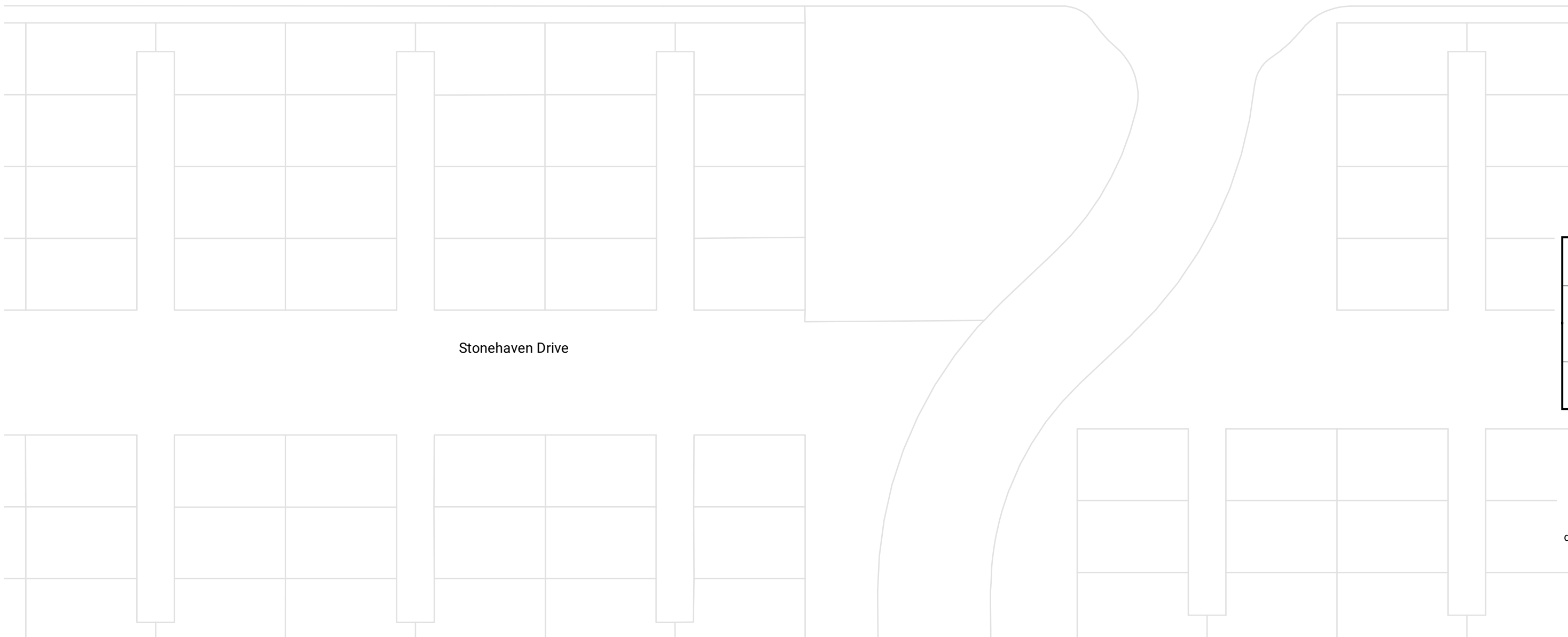

1 inch = 60 feet

NW 34 2N 1W 06082	NE 34 2N 1W 06082
SW 34 2N 1W 06082	SE 34 2N 1W 06082
NW 03 1N 1W 01088	NE 03 1N 1W 01089

S L B & M

NOTE: Distance, bearings and radius values are approximate. User needs to refer to the recorded legal descriptions for exact bearing and distances. For cadastral or technical information, see the dedicated plat and or legal descriptions in recorded documents.

