

GOLF MEADOWS WEST BOUNTIFUL

Tax ID Prefix

06-129

Plat ID: 2012

Sheet 1 of 1

Year Recorded: 1991

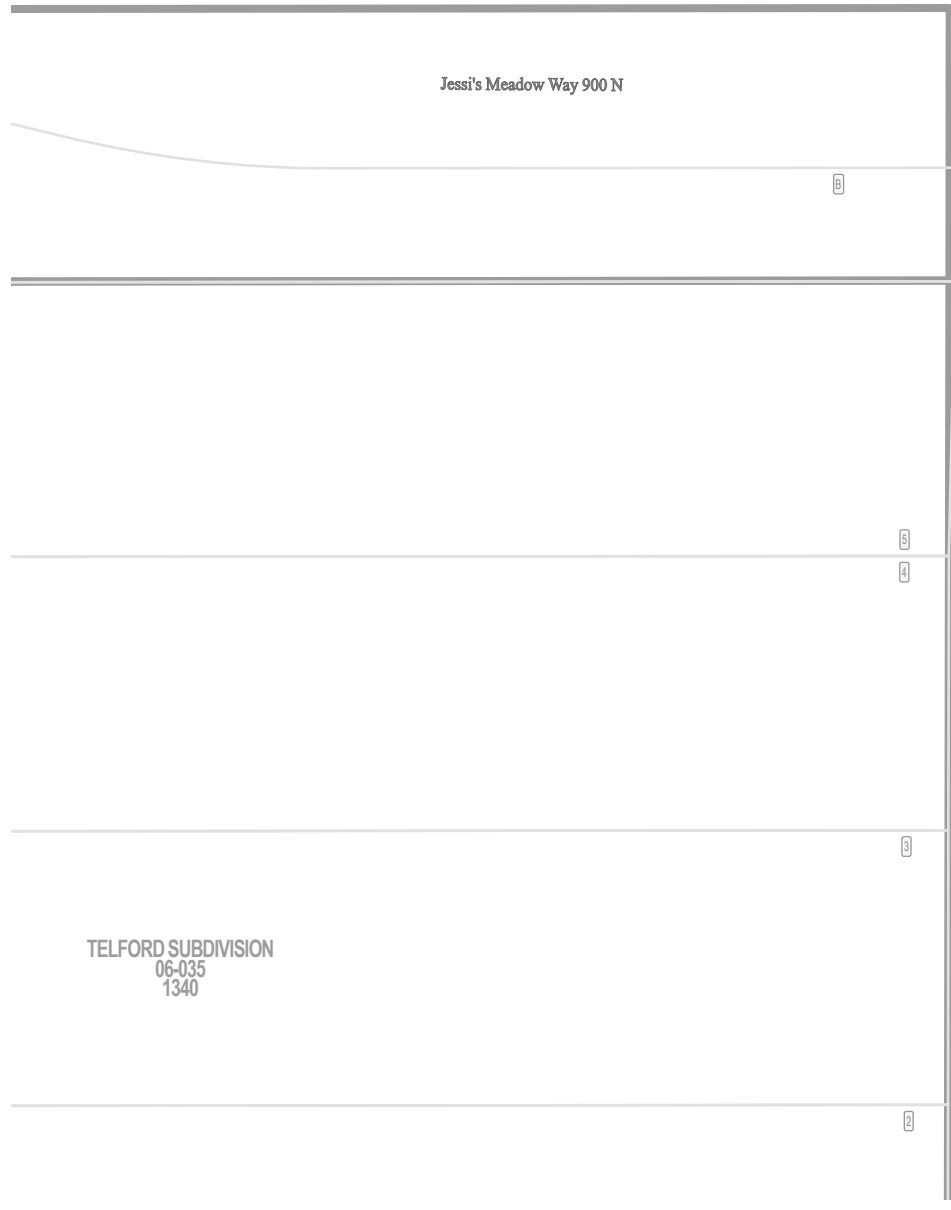
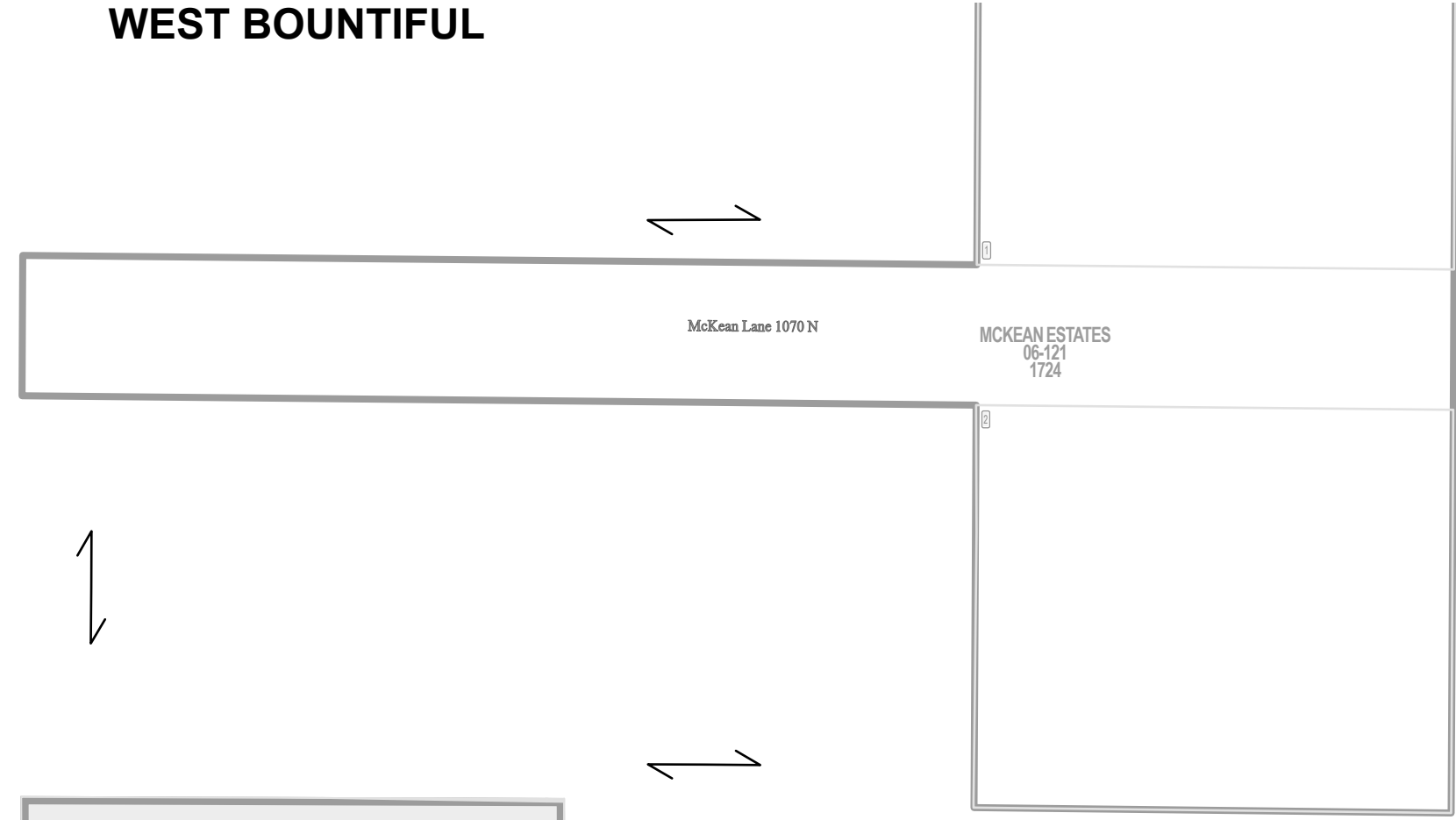

1100 West Howard St

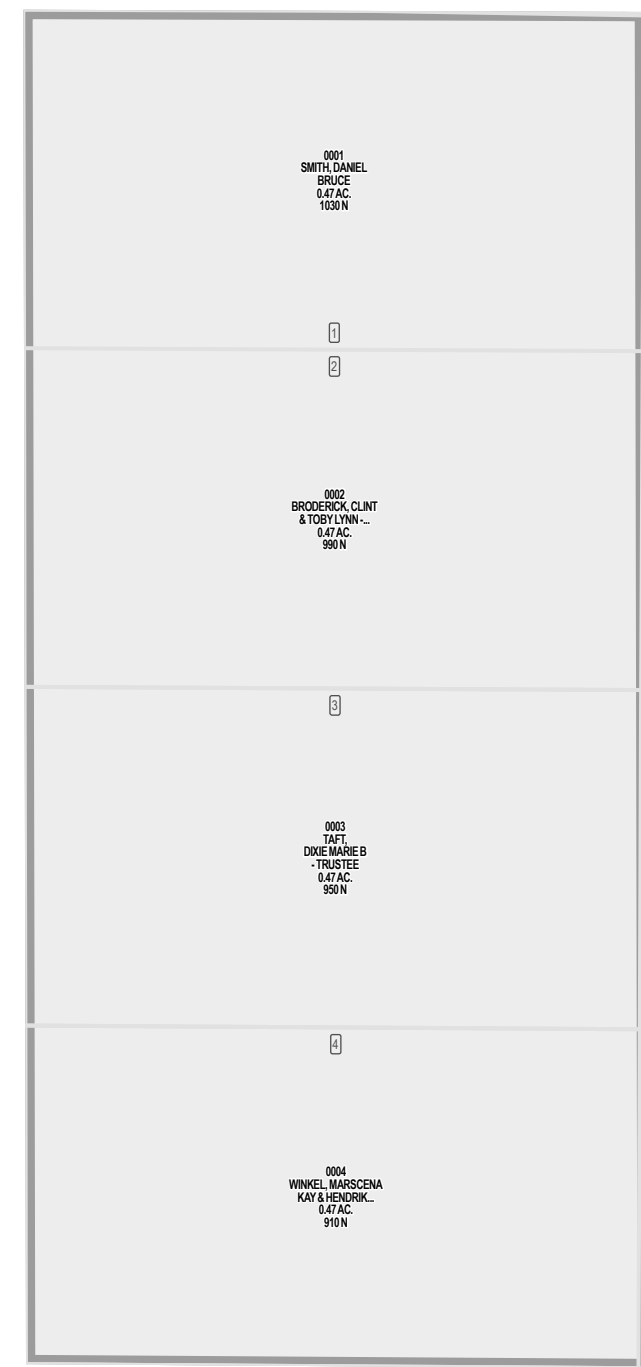

850 North



Parcel ID

Lot Number

1 inch = 60 feet

SE 14 2N 1W 06-027	SW 13 2N 1W 06-013
NE 23 2N 1W 06-032	NW 24 2N 1W 06-036

S L B & M

NOTE: Distance, bearings and radius values are approximate. User needs to refer to the recorded legal descriptions for exact bearing and distances. For cadastral or technical information, see the dedicated plat and or legal descriptions in recorded documents.

