

CEDAR SPRINGS CONDOMINIUM

CENTERVILLE

Tax ID Prefix

02-049

Plat ID: 989

Sheet 1 of 12

Year Recorded: 1976

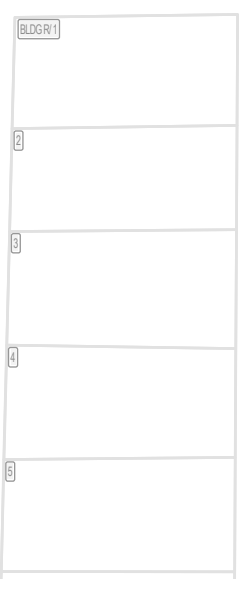
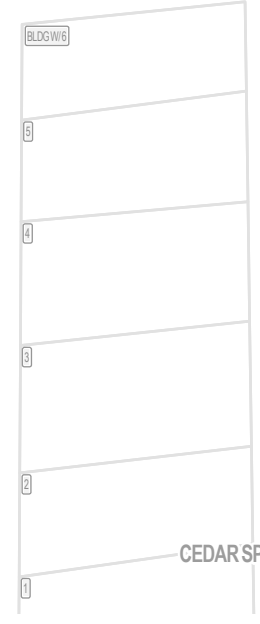
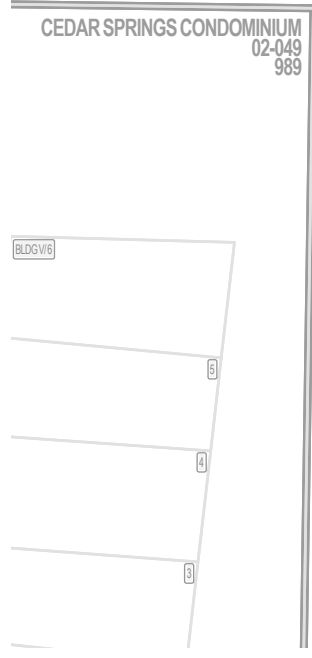
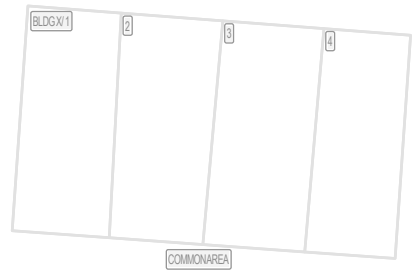
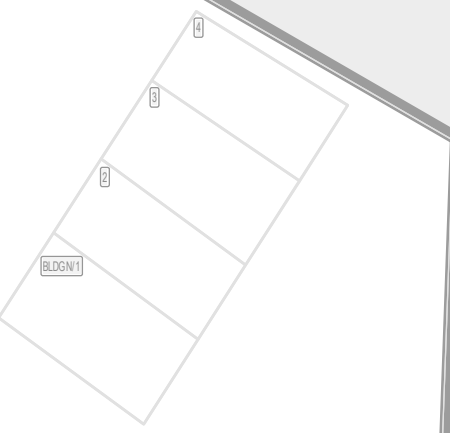

1.0204 ASSN OF UNIT OWN OF ... 9.99 AC.
1



Parcel ID

Lot Number

1 inch = 30 feet

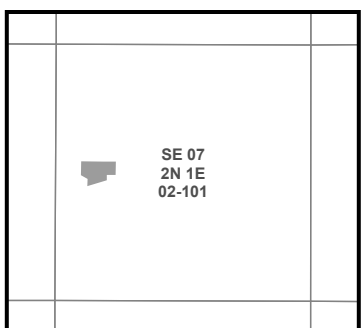

SLB & M

NOTE: Distance, bearings and radius values are approximate. User needs to refer to the recorded legal descriptions for exact bearing and distances. For cadastral or technical information, see the dedicated plat and or legal descriptions in recorded documents.



CEDAR SPRINGS CONDOMINIUM

CENTERVILLE

Tax ID Prefix

02-049

Plat ID: 989

Sheet 2 of 12

Year Recorded: 1976

COUNTRY COTTAGES PLAT B AMENDED, A PUD
02-162
2474

COUNTRY COTTAGES PLAT A AMENDED, A PUD
02-159
2427

COMMONAREA

02-049
989
CEDAR SPRINGS CONDOMINIUM
02-049
989

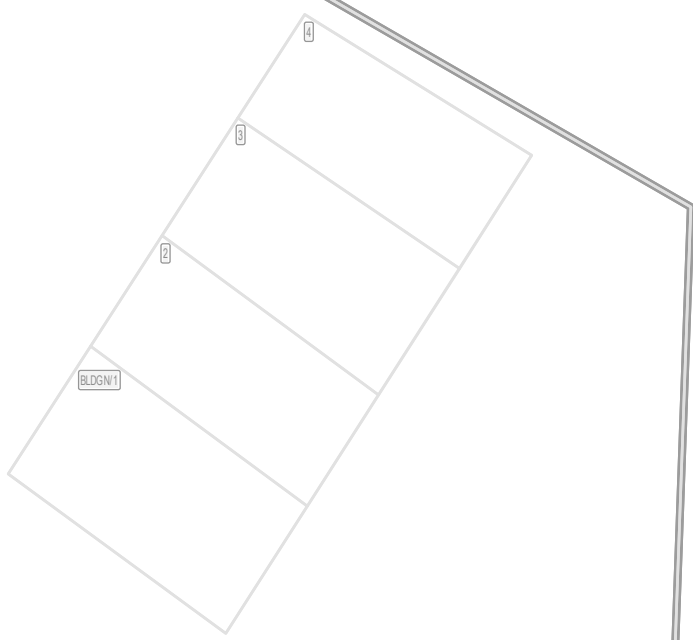

Parcel ID

Lot Number

1 inch = 20 feet

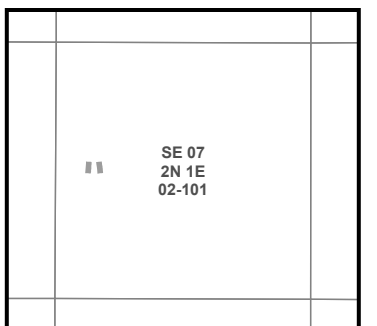

SLB & M

NOTE: Distance, bearings and radius values are approximate. User needs to refer to the recorded legal descriptions for exact bearing and distances. For cadastral or technical information, see the dedicated plat and or legal descriptions in recorded documents.



CEDAR SPRINGS CONDOMINIUM

CENTERVILLE

Tax ID Prefix

02-049

Plat ID: 989

Sheet 3 of 12

Year Recorded: 1976

COUNTRY COTTAGES PLAT B AMENDED, A PUD
02-162
2474

COUNTRY COTTAGES PLAT A AMENDED, A PUD
02-159
2427



02-049
989
CEDAR SPRINGS CONDOMINIUM
02-049
989



Parcel ID

Lot Number

1 inch = 20 feet

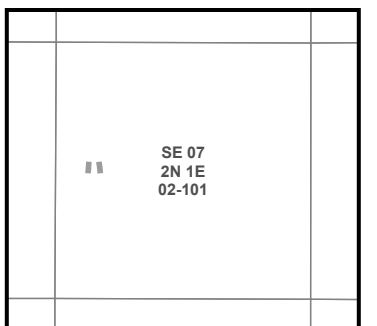

NOTE: Distance, bearings and radius values are approximate. User needs to refer to the recorded legal descriptions for exact bearing and distances. For cadastral or technical information, see the dedicated plat and or legal descriptions in recorded documents.



CEDAR SPRINGS CONDOMINIUM CENTERVILLE

Tax ID Prefix

02-049

Plat ID: 989

Sheet 4 of 12

Year Recorded: 1976



Parcel ID

Lot Number

1 inch = 30 feet

NW 07 2N 1E 02-024	NE 07 2N 1E 02-096
SW 07 2N 1E 02-026	SE 07 2N 1E 02-101
NW 18 2N 1E 03-001	NE 18 2N 1E 03-002

S L B & M

NOTE: Distance, bearings and radius values are approximate. User needs to refer to the recorded legal descriptions for exact bearing and distances. For cadastral or technical information, see the dedicated plat and or legal descriptions in recorded documents.



CEDAR SPRINGS CONDOMINIUM

CENTERVILLE DOMINIUM

Tax ID Prefix

02-049

Plat ID: 989

Sheet 6 of 12

Year Recorded: 1976

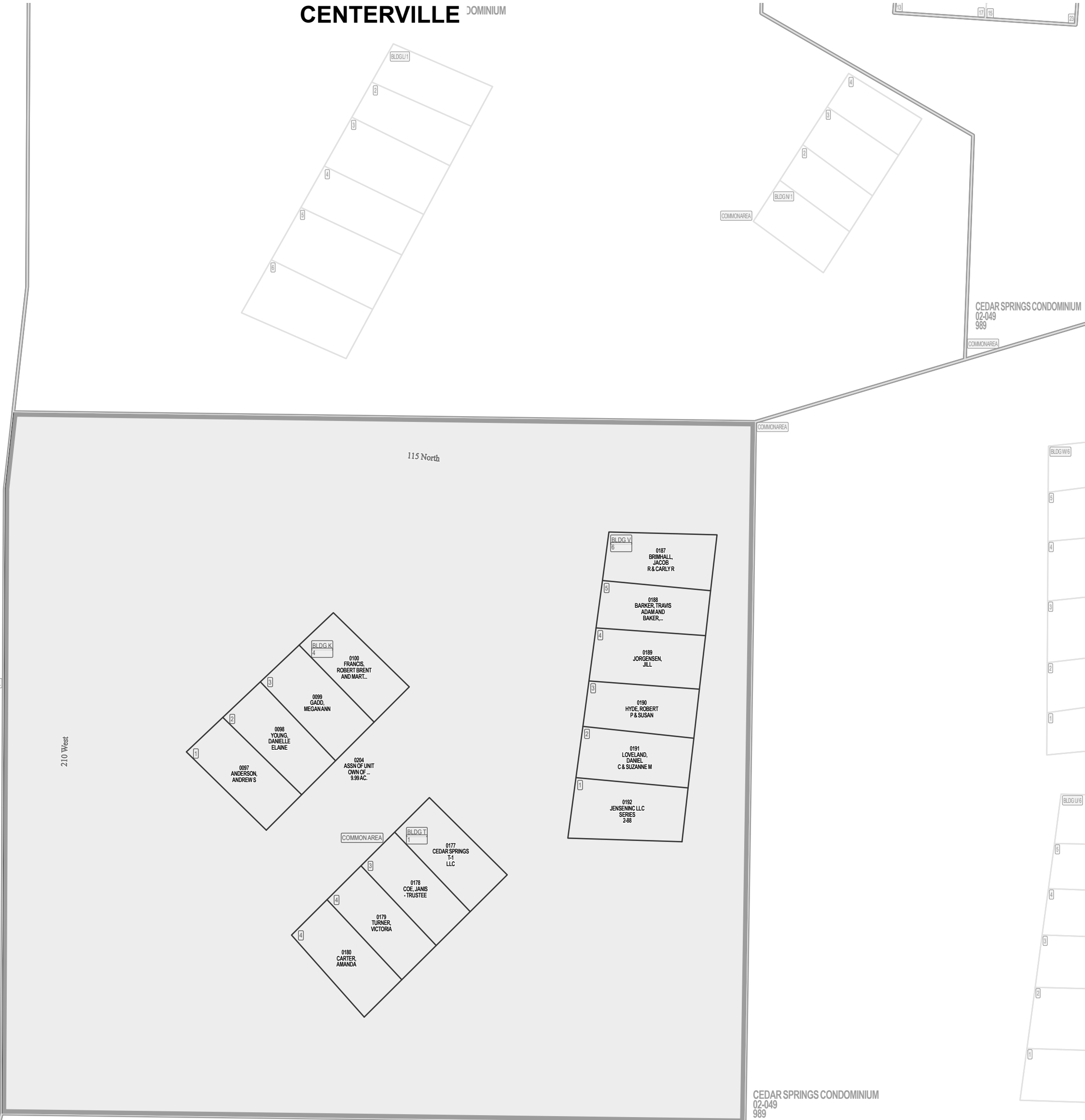
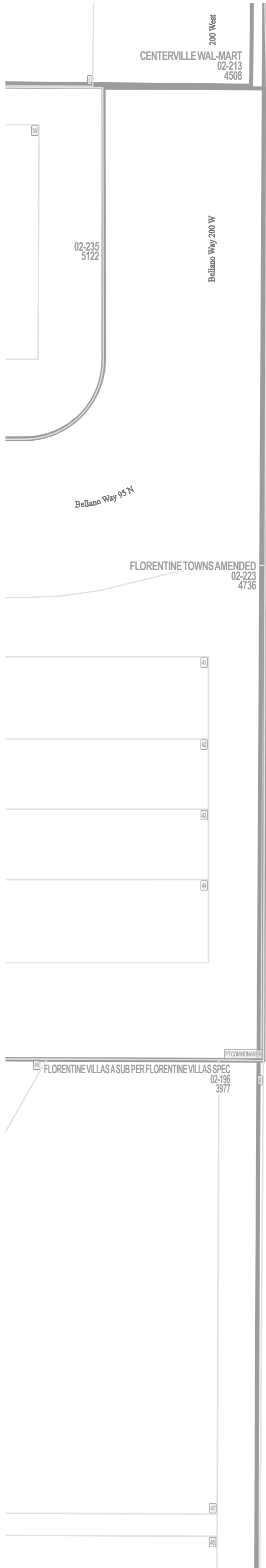

Parcel ID

Lot Number

1 inch = 30 feet

NW 07 2N 1E 02-024	NE 07 2N 1E 02-096
SW 07 2N 1E 02-026	SE 07 2N 1E 02-101
NW 18 2N 1E 03-001	NE 18 2N 1E 03-002

S L B & M

NOTE: Distance, bearings and radius values are approximate. User needs to refer to the recorded legal descriptions for exact bearing and distances. For cadastral or technical information, see the dedicated plat and or legal descriptions in recorded documents.



CEDAR SPRINGS CONDOMINIUM

CENTERVILLE

Tax ID Prefix

02-049

Plat ID: 989

Sheet 7 of 12

Year Recorded: 1976



SPRATLING COMMERCIAL SUBDIVISION
02-052
1414

CEDAR SPRINGS CONDOMINIUM
02-049
989

CEDAR SPRINGS CONDOMINIUM
02-049
989

CEDAR SPRINGS CONDOMINIUM
02-049
989

K&R SAMCO LLC COMMERCIAL SUBDIVISION
02-218
4616



Parcel ID

Lot Number

1 inch = 30 feet

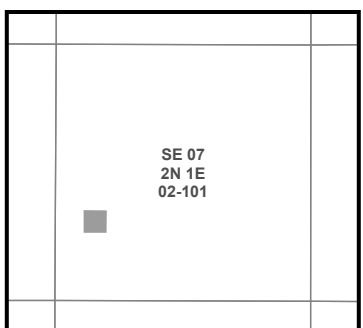

S L B & M

NOTE: Distance, bearings and radius values are approximate. User needs to refer to the recorded legal descriptions for exact bearing and distances. For cadastral or technical information, see the dedicated plat and or legal descriptions in recorded documents.



CEDAR SPRINGS CONDOMINIUM

Tax ID Prefix

02-049

Plat ID: 989

Sheet 8 of 12

Year Recorded: 1976

CENTERVILLE

FLORENTINE TOWNS AMENDED
02-223
4736

02-196
3977

CEDAR SPRINGS CONDOMINIUM
02-049
989

CEDAR SPRINGS CONDOMINIUM
02-049
989

CEDAR SPRINGS CONDOMINIUM
02-049
989

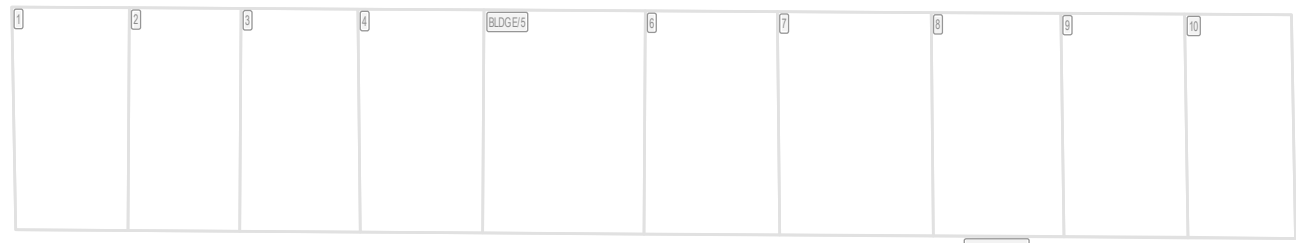
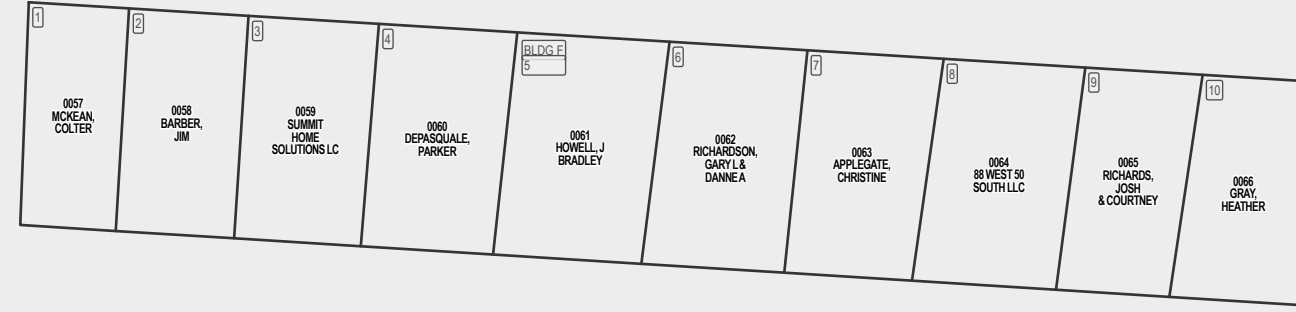
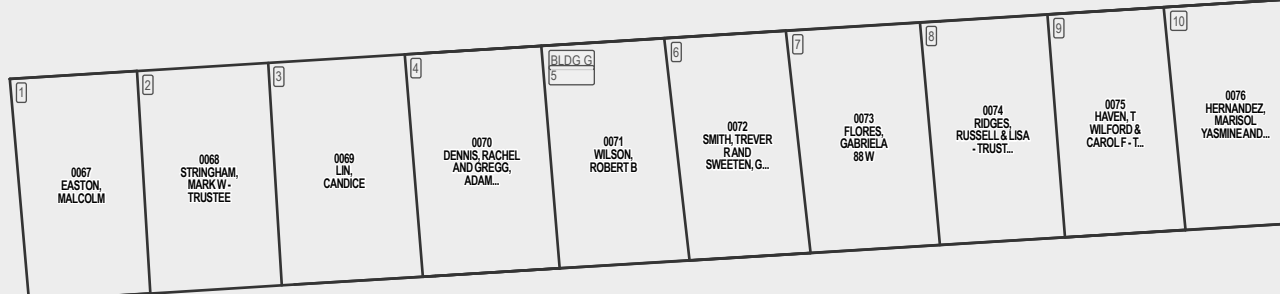
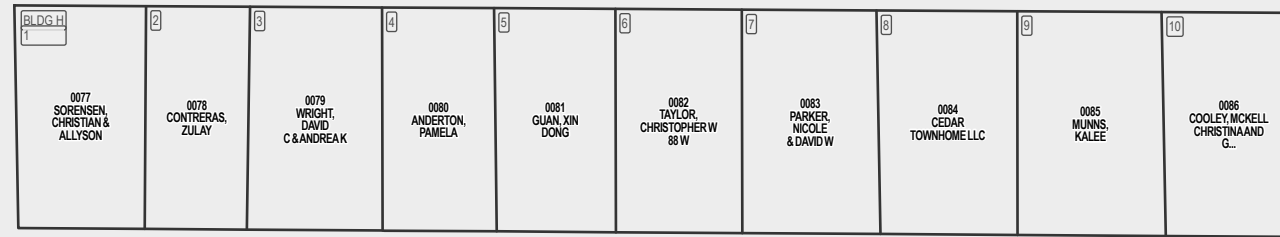
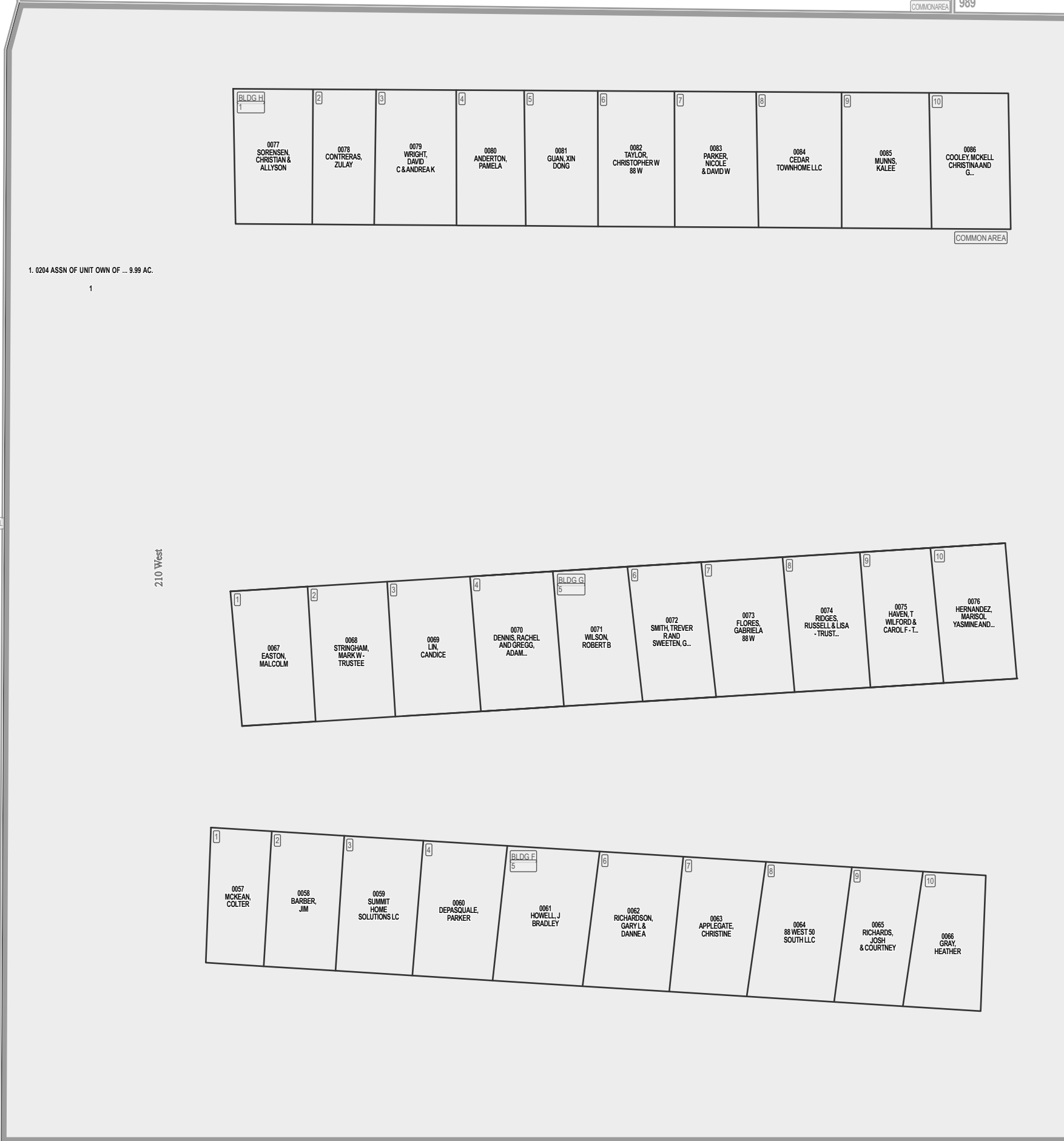

Parcel ID

Lot Number

1 inch = 30 feet

NW 07 2N 1E 02-024	NE 07 2N 1E 02-096
SW 07 2N 1E 02-026	SE 07 2N 1E 02-101
NW 18 2N 1E 03-001	NE 18 2N 1E 03-002

S L B & M

NOTE: Distance, bearings and radius values are approximate. User needs to refer to the recorded legal descriptions for exact bearing and distances. For cadastral or technical information, see the dedicated plat and or legal descriptions in recorded documents.



CEDAR SPRINGS CONDOMINIUM

CENTERVILLE

Tax ID Prefix

02-049

Plat ID: 989

Sheet 9 of 12

Year Recorded: 1976



Parcel ID

Lot Number

1 inch = 30 feet

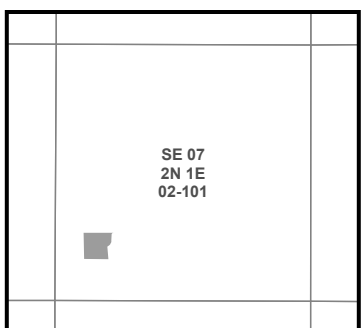

S L B & M

NOTE: Distance, bearings and radius values are approximate. User needs to refer to the recorded legal descriptions for exact bearing and distances. For cadastral or technical information, see the dedicated plat and/or legal descriptions in recorded documents.



CEDAR SPRINGS CONDOMINIUM CENTERVILLE

Tax ID Prefix

02-049

Plat ID: 989

Sheet 10 of 12

Year Recorded: 1976

50 South

CEDAR SPRINGS CONDOMINIUM
02-049
989

COMMON AREA

COMMON AREA

CEDAR SPRINGS CONDOMINIUM
02-049
989

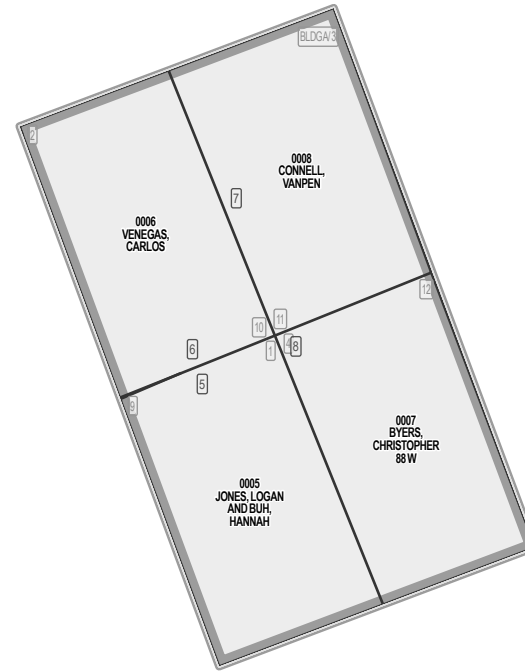

CEDAR SPRINGS CONDOMINIUM
02-049
989

70 West

02-218
4616

CEDAR SPRINGS CONDOMINIUM
02-049
989

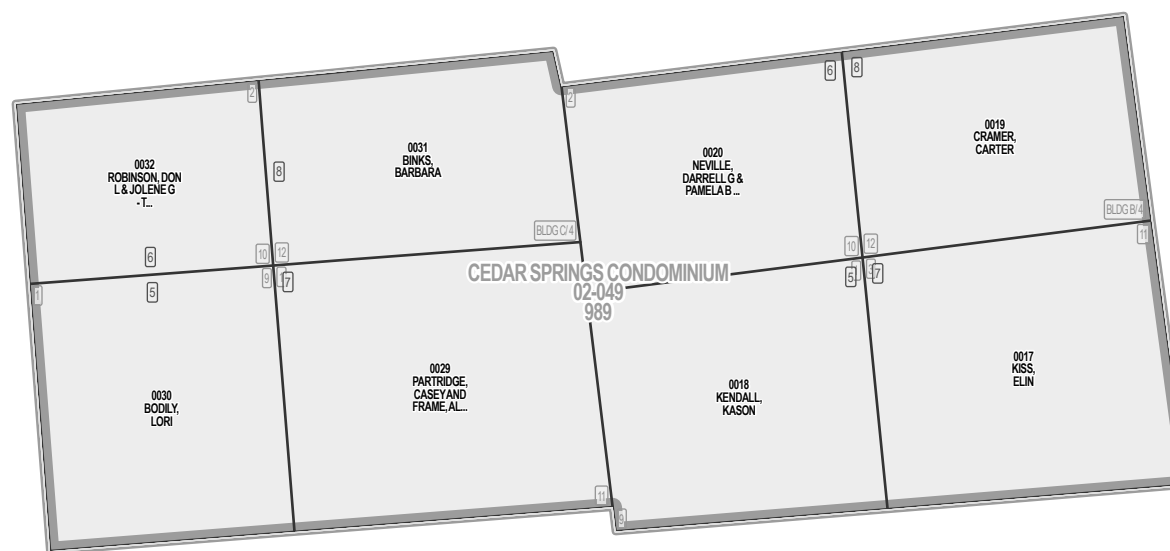

CEDAR SPRINGS CONDOMINIUM
02-049
989

125 South



Parcel ID

Lot Number

1 inch = 20 feet

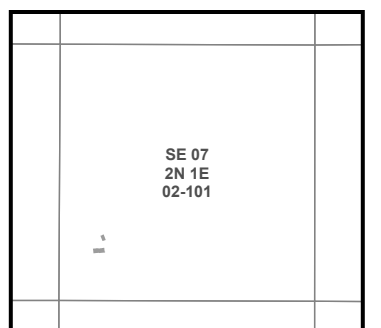

S L B & M

NOTE: Distance, bearings and radius values are approximate. User needs to refer to the recorded legal descriptions for exact bearing and distances. For cadastral or technical information, see the dedicated plat and or legal descriptions in recorded documents.



CEDAR SPRINGS CONDOMINIUM CENTERVILLE

Tax ID Prefix

02-049

Plat ID: 989

Sheet 11 of 12

Year Recorded: 1976

50 South

CEDAR SPRINGS CONDOMINIUM
02-049
989

COMMON AREA

CEDAR SPRINGS CONDOMINIUM
02-049
989

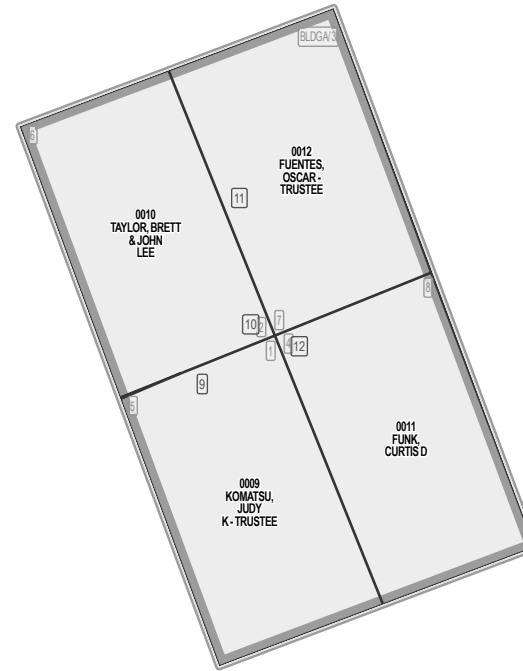

CEDAR SPRINGS CONDOMINIUM
02-049
989

70 West

02-218
4616

CEDAR SPRINGS CONDOMINIUM
02-049
989

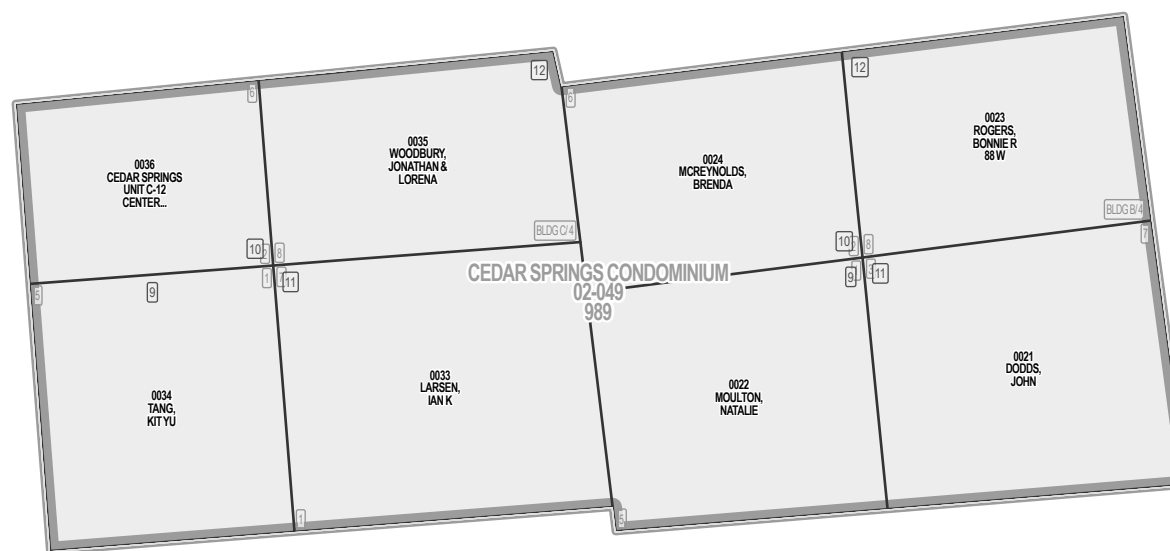

Parcel ID

Lot Number

1 inch = 20 feet

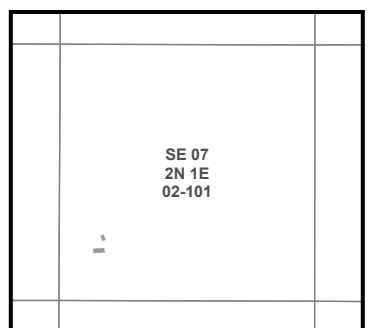

S L B & M

NOTE: Distance, bearings and radius values are approximate. User needs to refer to the recorded legal descriptions for exact bearing and distances. For cadastral or technical information, see the dedicated plat and or legal descriptions in recorded documents.

125 South

COMMON AREA



